

Tramway/Metro/Railway Composite Insulator

Composite Insulators for high speed rail, railway and tramway lines with the following advantages.

- Light weight
- Anti-vandalism
- Self-cleaning by rain
- Suitable for polluted areas
- Easy to store and handle
- Manufactured according to IEC standards, with third party type test reports.

Material:

- Steel/stainless steel or aluminium fittings
- HTV silicone rubber housing with FRP (Fiberglass reinforced plastic) core
- HTV silicone rubber housing with porcelain core

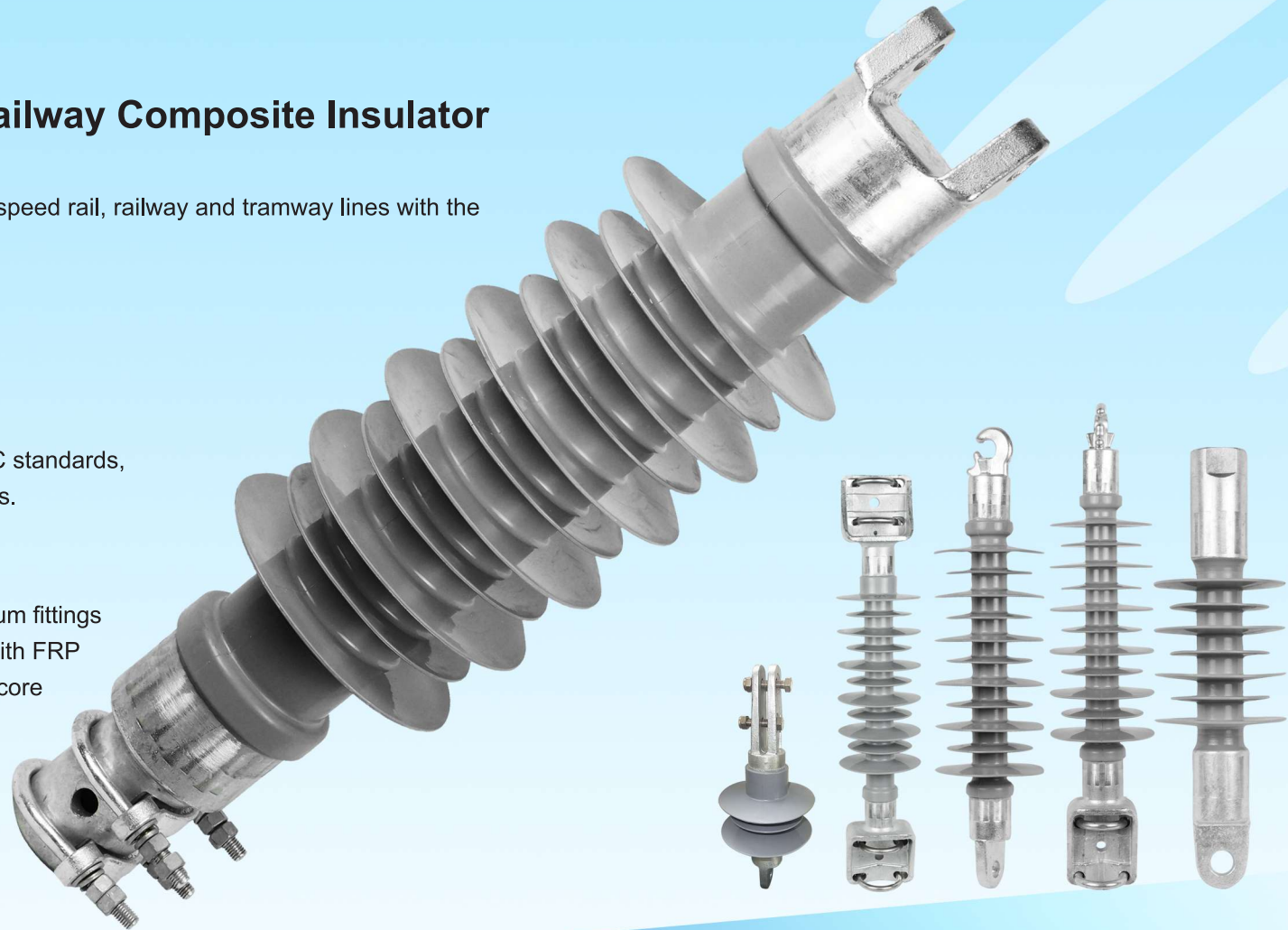

Tramway/Metro/Railway Composite Insulator

Cantilever Type

No.	Rated Voltage (kV)	Power frequency withstand (wet) 1min (kV)	Lightning Impulse withstand 1.2/50 μ s (kV)	Minimum creepage distance (mm)	Specified Tensile load (kN)	Specified Cantilever load (kN)	End fittings	Reference (Country/Area)
D0124-Q62-1	3	50	125	340	40	6.8	ϕ 57 Socket-Tongue	Italy
D0229-Q59-3	3	45	100	369	50	2.7	ϕ 72 Socket-Tongue	Poland
D0229-Q59-2	3	45	100	369	50	2.7	ϕ 62 Socket-Tongue	Poland
D0101-Q59-1	3	45	100	369	50	2.7	Twin bolt Clevis-Tongue	Poland
D0052-Q38-5	3.3	15	125	600	70	/	G1-A Socket-Tongue	Georgia
D0051-Q54-1	3.3	15	125	600	120	8	G1-A Socket-Tongue	Georgia
D0198-Q74-1	15	80	165	820	50	6.8	ϕ 38 Socket-Tongue	Italy
D0221-X74-2	15	80	165	820	50	6.3	ϕ 60 Socket-Tongue	Italy
D0045-Q38-3	15	100	250	1100	90	12	ϕ 55 Socket-Tongue	Norway
D0046-Q38-4	15	100	250	1100	90	12	ϕ 55 Socket- ϕ 55 Socket	Norway
D0078-Q38-9	25	100	250	1100	90	12	ϕ 42 Socket-Tongue	Finland
D0075-Q38-7	25	95	200	1070	22.3	5.2	ϕ 48 Socket-Tongue	New Zealand
D0074-Q38-6	25	95	200	1070	22.3	5.2	ϕ 48 Socket-Hook	New Zealand
D0076-Q38-8	25	95	200	1070	22.3	5.2	Tongue-Hook	New Zealand
D0077-Q47-1	25	130	200	1130	10.8	15	ϕ 48.3 Socket-Clevis	New Zealand
DSYJ-10019-2	25	200	/	1600	5.9	3.1	ϕ 48 Socket-Clevis (Hybrid)	Taiwan
D0062-Q55-1	27.5	120	250	1230	50	4.7	ϕ 70 Socket-Tongue	Italy
D0099-Q55-2	27.5	120	250	1230	50	4.7	ϕ 60 Socket-Tongue	Italy
D0130-Q55-3	27.5	120	250	1230	70	7.9	ϕ 70 Socket-Tongue	Italy
D0131-Q55-4	27.5	120	250	1230	70	7.9	ϕ 60 Socket-Tongue	Italy
D0167-Q55-5	27.5	120	250	1230	70	7.9	ϕ 60 Socket- ϕ 60 Socket	Italy
D0098-Q40-4	27.5	110	230	1600	/	1.8	ϕ 34 Tube- ϕ 62 Socket	China

Please provide your own drawings when inquiring.

Tramway/Metro/Railway Composite Insulator

Composite Insulators for high speed rail, railway and tramway lines with the following advantages.

- Light weight
- Anti-vandalism
- Self-cleaning by rain
- Suitable for polluted areas
- Easy to store and handle
- Manufactured according to IEC standards, with third party type test reports.



Material:

- Steel/stainless steel or aluminium fittings
- HTV silicone rubber housing with FRP (Fiberglass reinforced plastic) core
- HTV silicone rubber housing with porcelain core



Tramway/Metro/Railway Composite Insulator

Post Type

No.	Rated Voltage (kV)	Power frequency withstand (wet) 1min (kV)	Lightning Impulse withstand 1.2/50 μ s (kV)	Minimum creepage distance (mm)	Specified Tensile load (kN)	Specified Cantilever load (kN)	End fittings	Reference (Country/Area)
D0230-P44-3	3	48	85	385	14 (Compression)	14	M30 Pin-Stud	Italy
D0015-Z44-1	15	75	100	720	/	4	Flange-Flange, AL alloy, 76mm PCD	Norway
D0018-Z48-1	15	110	235	1041	40	Max.80mm deflex.@10kN	Flange-Flange,76mm PCD&1xM20 center hole	Norway
D0094-Z58-2	15	75	100	690	/	20	Flange-Flange, 127mm PCD	Italy
D0141-Z38-11	15	80	180	870	30	9.5	Flange-Flange,76mm PCD	Switzerland
D0186-Z73-1	25	125	250	1255	70	16	Flange-Flange,76mm PCD	Hongkong
D0178-Z58-3	27.5	110	250	1200	80	12	Flange-Flange, 127mm PCD	Italy
D0094-Z58-1	27.5	95	250	1100	80	12	Flange-Flange, 127mm PCD	Italy
D0111-Z40-6	27.5	150	310	1900	80	6	Flange-Flange,89/172mm PCD	China
D0149-Z66-1	27.5	125	250	1255	70	9	Flange-Flange,76mm PCD	Switzerland

Please provide your own drawings when inquiring.

Tramway/Metro/Railway Composite Insulator

Composite Insulators for high speed rail, railway and tramway lines with the following advantages.

- Light weight
- Anti-vandalism
- Self-cleaning by rain
- Suitable for polluted areas
- Easy to store and handle
- Manufactured according to IEC standards, with third party type test reports.

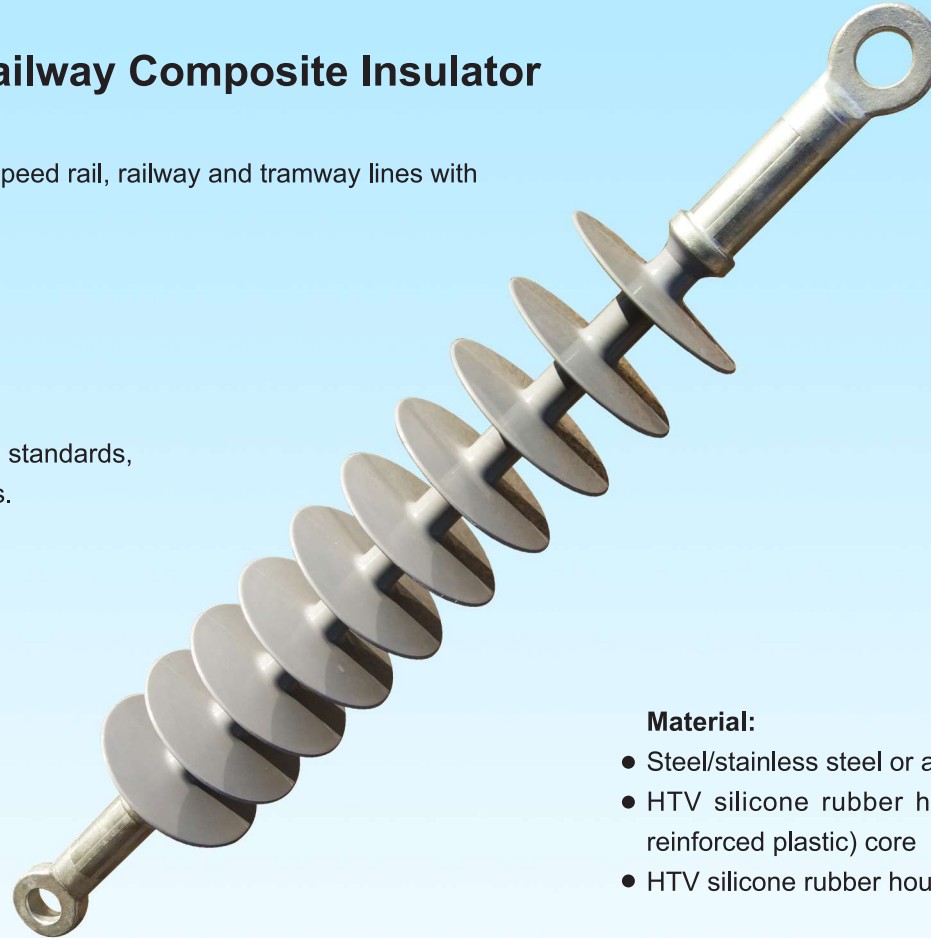

Material:

- Steel/stainless steel or aluminium fittings
- HTV silicone rubber housing with FRP (Fiberglass reinforced plastic) core
- HTV silicone rubber housing with Porcelain core

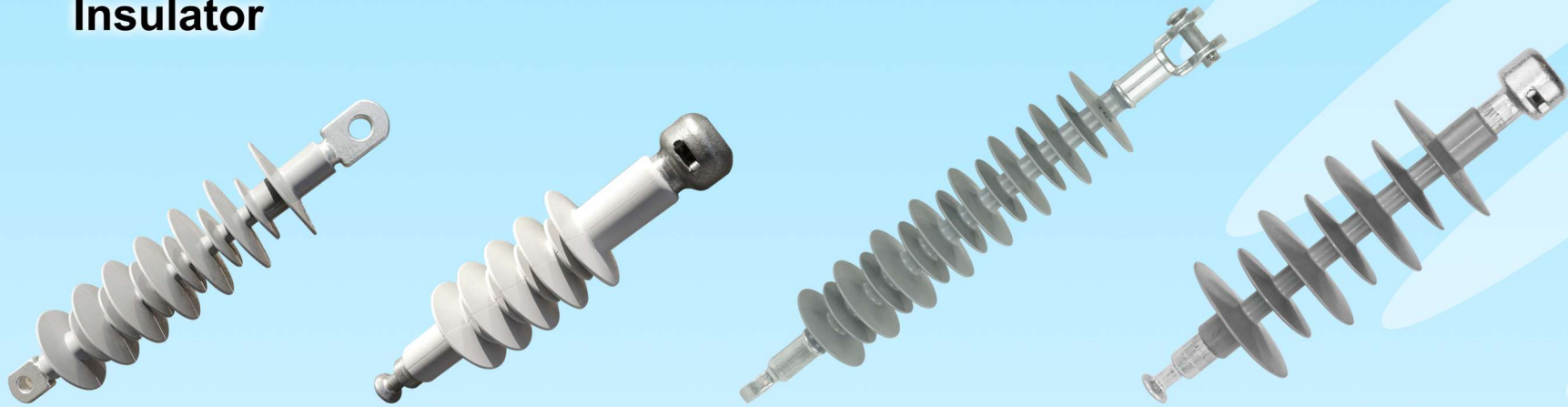

Tramway/Metro/Railway Composite Insulator Suspension Type

No.	Rated Voltage (kV)	Power frequency withstand (wet) 1min (kV)	Lightning Impulse withstand 1.2/50 μ s (kV)	Minimum creepage distance (mm)	Specified Tensile load (kN)	Specified Cantilever load (kN)	End fittings	Reference (Country/Area)
D0013-X21-1	3	40	100	350	70	/	Tongue-Tongue	Finland
D0053-X28-2	3.3	15	125	600	70	/	Ball-Socket, IEC 120,16mm	Georgia
D0054-X28-3	3.3	15	125	600	70	/	Tongue-Socket, IEC 120,16mm	Georgia
D0213-X76-1	3.3	15	125	600	120	/	Ball-Socket, IEC 120,16mm	Georgia
D0214-X76-2	3.3	15	125	600	120	/	Tongue-Socket, IEC 120,16mm	Georgia
D0047-Q11-1	15	114	225	1100	74	/	Tongue-Tongue	Norway
D0012-Q43-1	25	105	200	1080	110	/	Tongue-Tongue	Finland
D0187-X72-1	25	125	250	1230	135	/	Tongue-Tongue	Hongkong
D0106-X30-4	25	150	310	2000	120	/	Tongue-Tongue	China
D0063-Q56-1	27.5	120	250	1230	135	/	Tongue-Tongue	Italy

Please provide your own drawings when inquiring.

Tramway/Metro/Railway Composite Insulator

Composite Insulators for high speed rail, railway and tramway lines with the following advantages.

- Light weight
- Anti-vandalism
- Self-cleaning by rain
- Suitable for polluted areas
- Easy to store and handle
- Manufactured according to IEC standards, with third party type test reports.

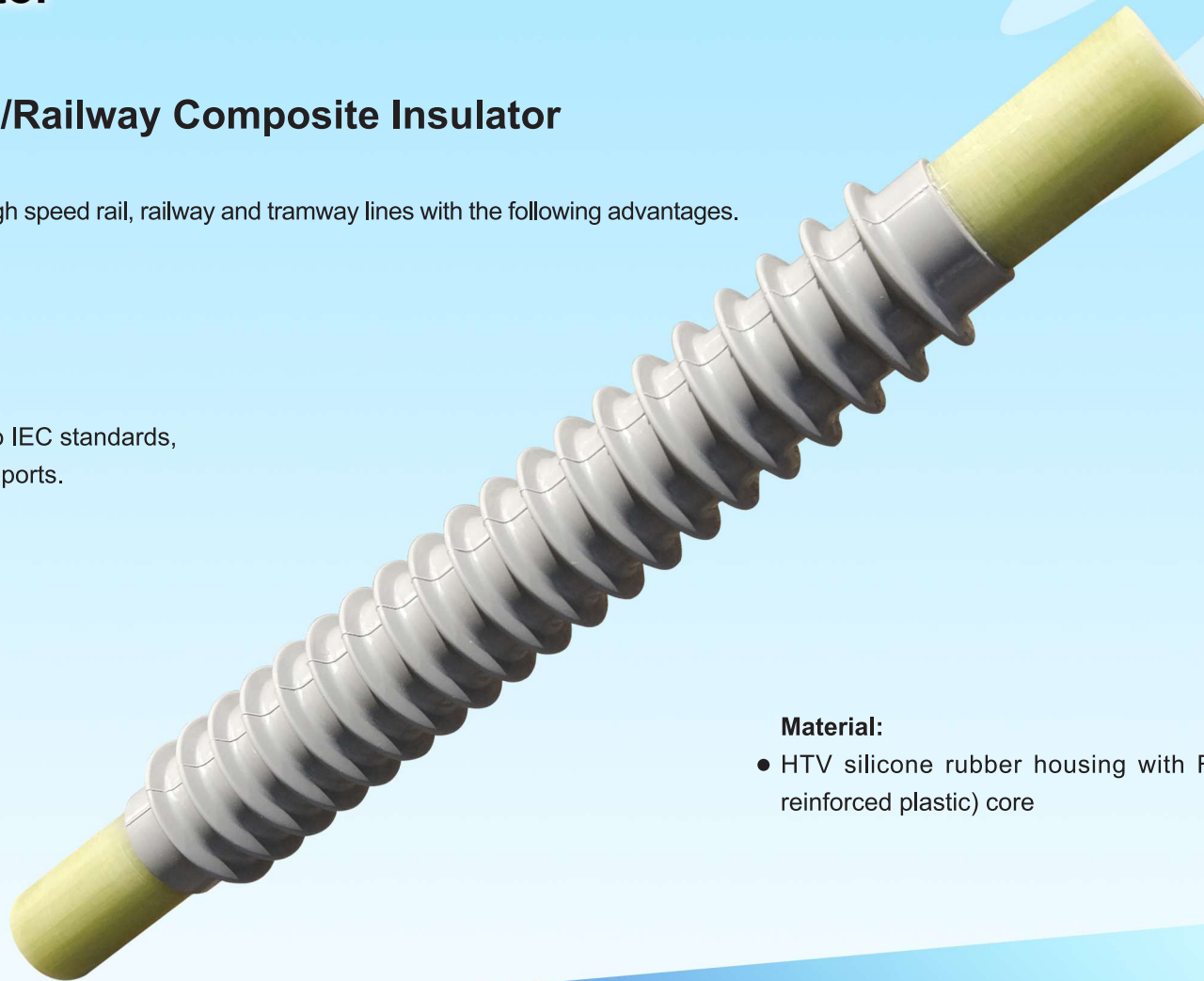

Material:

- HTV silicone rubber housing with FRP (Fiberglass reinforced plastic) core

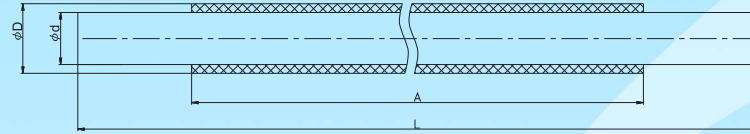

Tramway/Metro/Railway Composite Insulator					
Epoxy fiberglass rod with silicone rubber cover					
No.	Length L (mm)	Length A (mm)	Rod dia. d (mm)	Outer dia.D (mm)	Reference (Country/Area)
D148-G06-1	3840	3710	20	23	Italy
D0068-G04-2	923	803	20	26	Italy
D0064-G01-1	330	210	23	29	Italy
D0065-G02-1	450	350	24	30	Italy
D0066-G03-1	730	610	30	34	Italy
D0072-G05-1	710	610	34	40	Italy

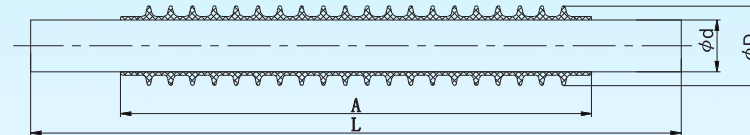

Epoxy fiberglass rod with silicone rubber cover and rib					
No.	Length L (mm)	Length A (mm)	Rod dia. D (mm)	Outer dia.D (mm)	Reference (Country/Area)
D0108-G60-1	196	96	21	46	Italy
D0156-G67-1	252	152	30	46	Italy
D0073-G57-1	377	273	30	38	Italy

Please provide your own drawings when inquiring.